

REVISIONS		
REV.	DESCRIPTION	DATE
-	INITIAL RELEASE PER ECD 05926 JP	02/25/10

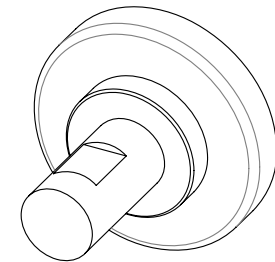
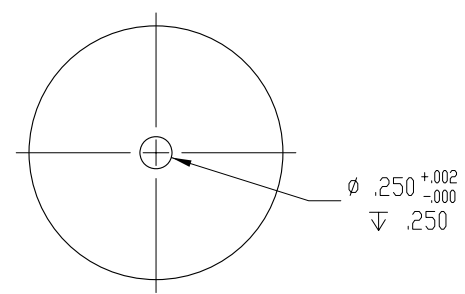
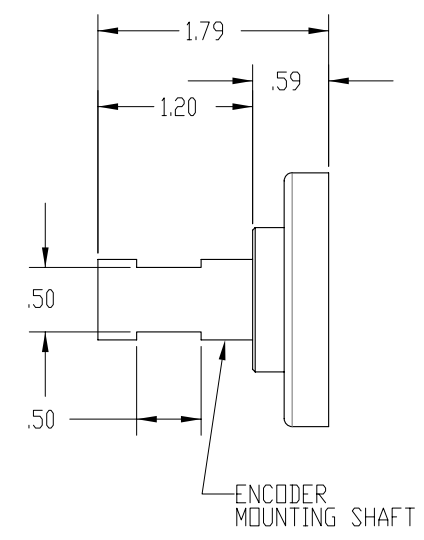
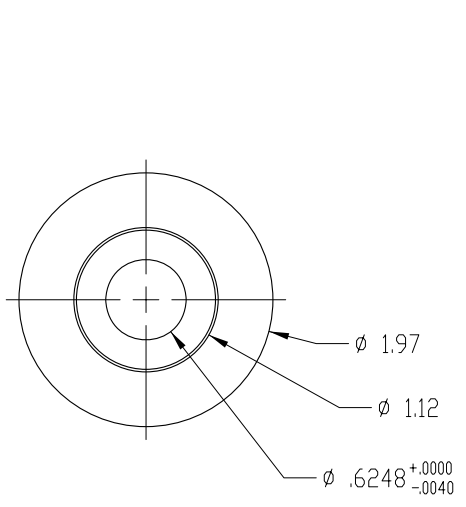

**NOTES:**

1. DANGER: MAGNETIC COUPLING CONTAINS A POWERFUL MAGNET WITH OVER 50 POUNDS PULLING FORCE.
2. DO NOT PLACE ANYTHING BETWEEN MAGNET AND METAL, PERSONAL INJURY MAY OCCUR.
3. IT IS RECOMMENDED THAT YOU COVER THE END OF MACHINE SHAFT WITH SILICONE GREASE BEFORE INSTALLING MAGNETIC COUPLING.
4. ATTACH MAGNETIC COUPLING ONTO THE CENTER OF THE SHAFT. (ABSOLUTE CENTER IS NOT NECESSARY.)
5. MAGNETIC COUPLING IS RATED FOR 300 RPM MAXIMUM.

THIRD ANGLE PROJECTION				ENCODER PRODUCTS COMPANY		www.encoder.com	
APPROVALS		DATE		NAME AND TITLE			
DRAWN		TLM		1/26/10		MAG COUPLING KIT FOR 5/8" SHAFT	
ISSUE DATE		TOLERANCES		CHECKED		REV.	
02/25/10		DECIMAL ± .005		RESP ENG		-	
NEXT ASSEM 176282-01		DECIMAL ± .01		MFG ENG		DWG. NO. MAG-CON1	
PREV. ASSEM		ANGULAR ± 1		QUAL ENG		SCALE: NONE	
PART NUMBER 176282		DWG. SIZE: B		SHEET 1 OF 1			